



INSULATED BLANK-OFF PANELS

pan-in-pan design / rigid insulation core

Model:
BLNK-X

BLANK-OFF PANEL DESCRIPTION

Insulated / non-insulated blank-off panels designed to block all or a portion of any stationary R&S model louver. Blank-off panels are mounted on the rear of the louver face secured by factory installed J-Clip brackets. Panels are removeable. Customer to provide blank-off dimensions and mounting location when ordering. Screens are not typically used when blank-off panels are installed.

BLANK-OFF PANEL CONSTRUCTION

- **PANEL SKINS:** 20 GA galvanized steel or 0.063" aluminum pans, mechanically fastened
- **INSULATION:** Standard 1" fire rated closed cell polyisocyanurate (polyiso) foam core with aluminum foil facer
- **PERFORMANCE:** 1" standard insulation achieves R7.2
- **CONSTRUCTION:** Single sheet with formed pans (skins) that enclose insulation core

BRACKET ASSEMBLY

- Blank-off panel bracket mechanically fastened to louver
- Bracket constructed of 18 GA Galvanized Steel (S) or 0.063" Aluminum (A) - to be consistent with blank-off panel material

OPTIONS

- **FINISH:** – Baked Polyester – Kynar
- **INSULATED:** 2" fire rated closed cell polyisocyanurate (polyiso) foam core with aluminum foil facer achieves 13.1 R-Value
- **NON-INSULATED:** No insulation within Interior / Exterior Pan
- Welded bracket installation for high wind load tolerance
- Stainless steel construction

Insulated	Aluminum	2.25 LBS / SF
Insulated	Steel	3.90 LBS / SF
Non-Insulated	Aluminum	1.89 LBS / SF
Non-Insulated	Steel	3.55 LBS / SF

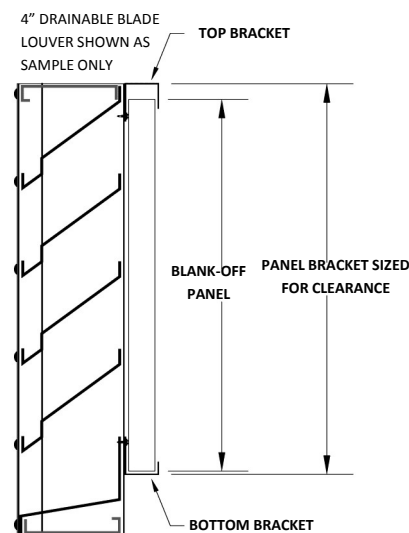
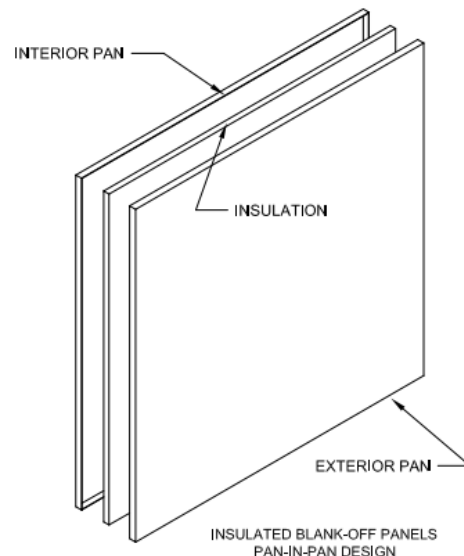

TAG	QTY	WIDTH "W"	HEIGHT "H"	MATERIAL	FINISH / OPTIONS

Customer

Job Name _____ Model _____

Architect _____ Date _____

