



# VERTICAL SCREEN

formed aluminum sight proof

**Model:**  
**FA-2580**

**CONSTRUCTION**

- **FRONT BLADES:** 2-1/2" deep, 7" wide, 12" to 13-3/4" on center, 0.080" 5052H32 high strength aluminum
- **BACK BLADES:** 3/4" deep, 9" wide, 12" to 13-3/4" on center, 0.080" 5052H32 high strength aluminum
- **HORIZONTAL SUPPORTS:** 2" x 2" x 3/16" angle
- **FINISH:** Mill or custom when indicated
- Welded blade assemblies with mechanical fasteners to horizontal support bars
- Minimum Panel Size: 24" x 12", Maximum Panel Size: 96" x 120"
- Approximate weight: 5 lbs. per square foot

**FEATURES**

- Sight proof vertical screen fabricated of 5052H32 aluminum
- Designed to withstand a 20 PSF wind load
- Concealed fasteners attach to rear support structure
- Variable blade spacing provides flexibility in sizing

**OPTIONS**

- Finish options: – Baked polyester – Kynar – Anodized
- Heavy duty bracing (high wind loads)
- Corner fabrications to close gaps

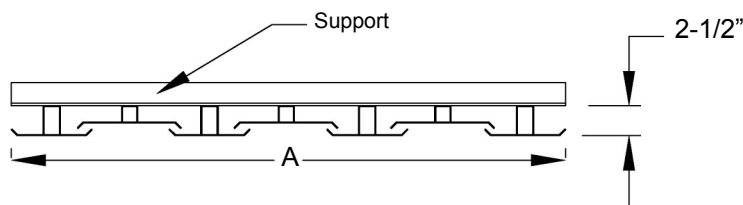
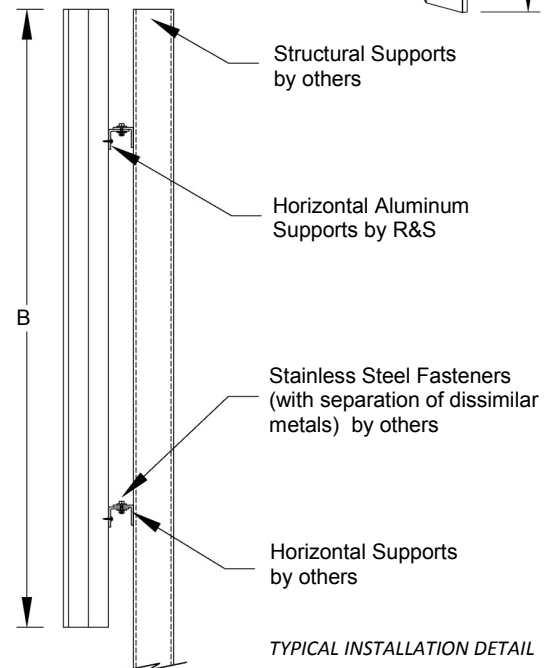
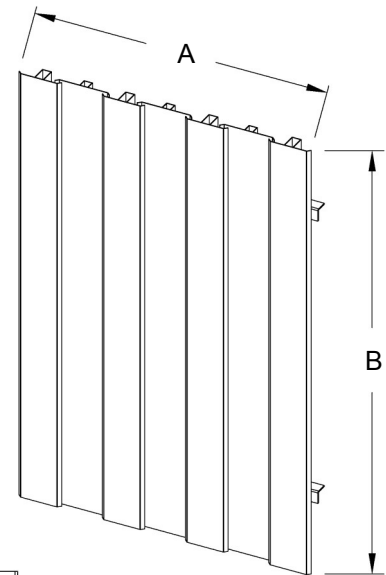

TAG	QTY	WIDTH "A"	HEIGHT "B"	FINISH	OPTIONS

<b>Customer</b>	
Job Name	Location
Architect	Date

